

DRAWING NO:	MATERIAL:	ORIGIN:
S-1903-4	LCP E4008	SZ

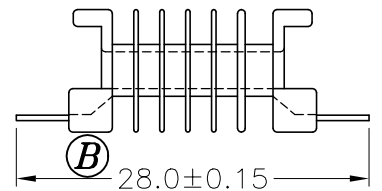

DRAWING NO:	MATERIAL:	ORIGIN:
S-1903-3	LCP E4008	SZ

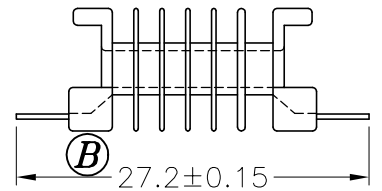

DRAWING NO:	MATERIAL:	ORIGIN:
S-1903-2	LCP E4008	SZ

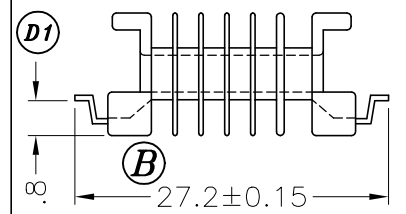

REV.	REVISIONS	REC.	REV.	REVISIONS	REC.
1	(B2): 22.2±0.15->22.0±0.15				
2	CANCEL (B2),(T),(K); UPDATE DRAWING.				

DRAWN & DRAFTED BY LIU YOU SEN	TOLERANCES		ANGLE:	TITLE:	
	0<L≤4 ±0.1	COPLANARITY 0.1 MAX	±1°	SMD BOBBIN EPC-19 (6 SEC)	
CHECKED & APPROVED BY TIAN BAI SEN	4<L≤16 ±0.2		UNIT:	BOBBIN MATERIAL:	UL REC.
	16<L≤63 ±0.3		MM	LCP E4008	UL 94V-0
PIN SHINE INDUSTRIAL CO., LTD. TEL:886-2-22990545 FAX:886-2-22990546			ORIGIN:	PIN MATERIAL:	PIN TENSION LOAD:
			SZ	PHOSPHOR BRONZE	1.5KG MIN
			DATE:	DRAWING NO.	REV.
			APR.04 '2003	S-1903-1	2