

DRAWING NO.	MATERIAL:	ORIGIN:
S-1103-2	PM9630	DG

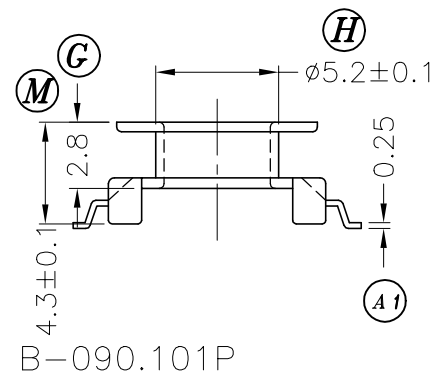

DRAWING NO.	MATERIAL:	ORIGIN:
S-1103-1	LCP E4008	DG

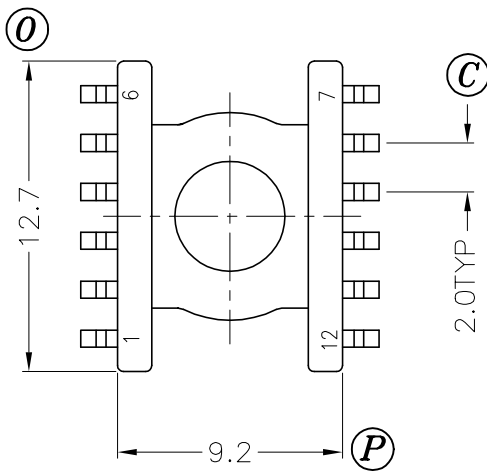
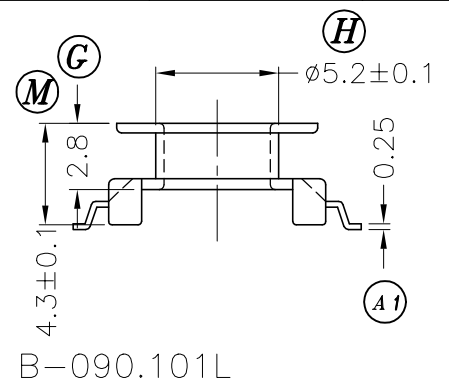

REV.	REVISIONS	REC.	REV.	REVISIONS	REC.
1	TERMINAL MODIFIED FROM 0.7X0.25 TO 0.7X0.3.				
2	CANCEL(Q); PIN TENSION LOAD 1.0KG-->1.5KG; UPDATE DRAWING				

DRAWN & DRAFTED BY YAN WEI MING	TOLERANCES		ANGLE:	TITLE:	
	0 < L ≤ 4 ± 0.1	COPLANARITY 0.1 MAX	± 1°	SMD BOBBIN ER-11/5	
CHECKED & APPROVED BY JOHN RONG	4 < L ≤ 16 ± 0.2		UNIT:	BOBBIN MATERIAL:	UL REC.
	16 < L ≤ 63 ± 0.3	MM	LCP E4008	UL 94V-0	
PIN SHINE INDUSTRIAL CO., LTD. TEL: 886-2-22990545 FAX: 886-2-22990546		ORIGIN:	PIN MATERIAL:	PIN TENSION LOAD:	
		DG	PHOSPHOR BRONZE	1.5KG MIN	
			DATE:	DRAWING NO.	REV.
			APR.03 '2003	S-1103	2