

DRAWING NO:	MATERIAL:	ORIGIN:
S-707-2	LCP E4008	SZ

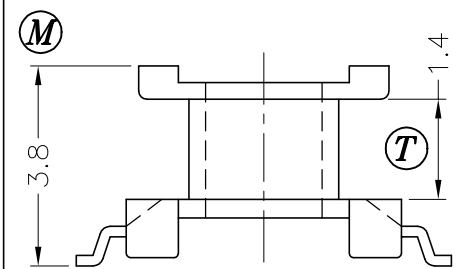

DRAWING NO:	MATERIAL:	ORIGIN:
S-707-1	PM9630	DG

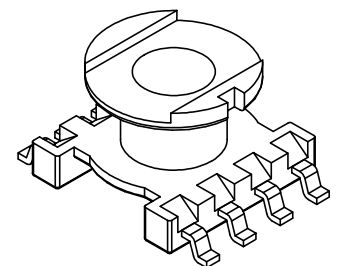

B-099.101L

B-099.101P

REV.	REVISIONS	REC.	REV.	REVISIONS	REC.
1	CANCEL (P),(R),(S),(Q); ADD (T),(U); UPDATE DRAWING.				

DRAWN & DRAFTED BY ZHANG ZHI QIANG	TOLERANCES		ANGLE:	TITLE:	
	0<L≤4 ±0.1	COPLANARITY 0.1 MAX	±1°	SMD BOBBIN ER-7.5	
CHECKED & APPROVED BY JOHN RONG	4<L≤16 ±0.2		UNIT:	BOBBIN MATERIAL:	UL REC.
	16<L≤63 ±0.3	MM	LCP E4008	UL 94V-0	
PIN SHINE INDUSTRIAL CO., LTD. TEL:886-2-22990545 FAX:886-2-22990546		ORIGIN:	PIN MATERIAL:	PIN TENSION LOAD:	
		DG	PHOSPHOR BRONZE	1.0KG MIN	
		DATE:	DRAWING NO.	REV.	
		APR.02 '2003	S-707	1	