

SEC.B-B

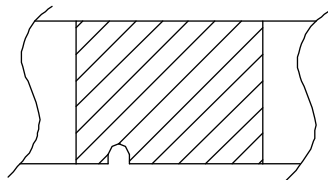

SEC.A-A

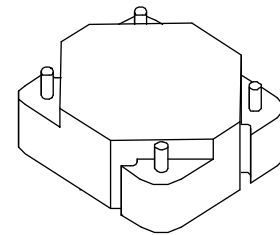
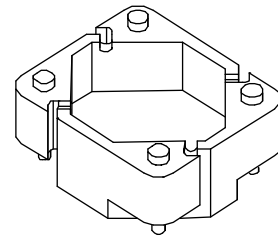

NOTE:

PIN PULL-OUT FORCE SHOULD BE
0.8kg MIN. BEFORE SOLDERING
1.2kg MIN. AFTER SOLDERING

REV.	REVISIONS	REC.	DATE	REV.	REVISIONS	REC.	DATE

DRAWN & DRAFTED BY SAND WANG	TOLERANCES		ANGLE: ±1°	TITLE: T-H BASE 10.1X8.75X5			
	0<L≤4 ±0.1	pin pitch ±0.2	UNIT: MM	BOBBIN MATERIAL: DAP AM113		UL REC. UL 94-V0	
CHECKED & APPROVED BY JOHN RONG	4<L≤16 ±0.2		ORIGIN: DG	PIN MATERIAL: PHOSPHOR BRONZE		PIN TENSION LOAD:	
	16<L≤63 ±0.3			DATE: AUG.02 '2004	DRAWING NO. PB-022-2	REV. 0	



PIN SHINE INDUSTRIAL CO., LTD.

TEL:886-2-22990545

FAX:886-2-22990546

