

DRAWING NO.	MATERIAL:	ORIGIN:
P-1904-4	PET FR530	DG SZ

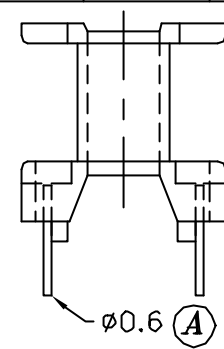

DRAWING NO.	MATERIAL:	ORIGIN:
P-1904-3	PBT 4130	DG

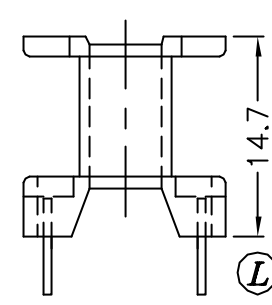

DRAWING NO.	MATERIAL:	ORIGIN:
P-1904-2	PET FR530	DG

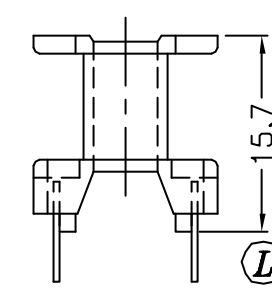

DRAWING NO.	MATERIAL:	ORIGIN
P-1904-1	PET FR530	DG SZ

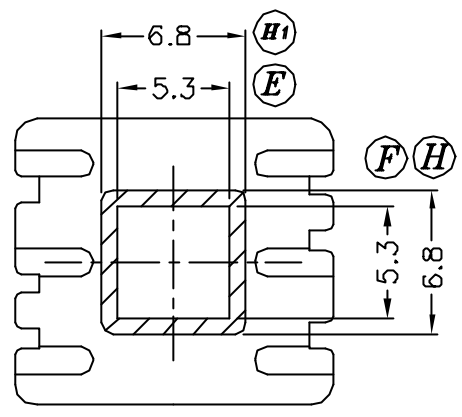
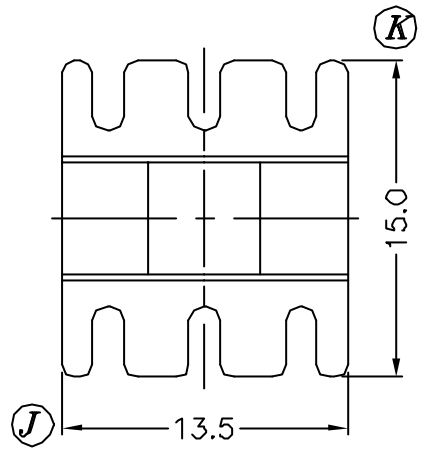
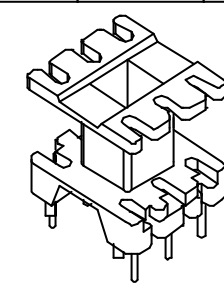

SEC. A-A

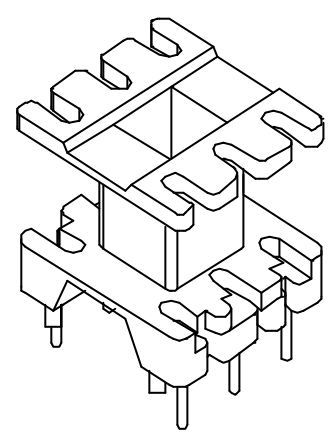
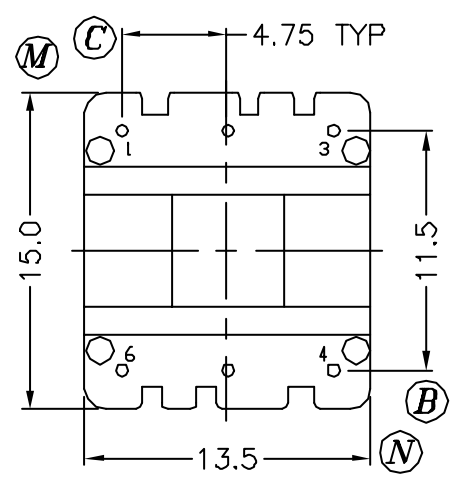
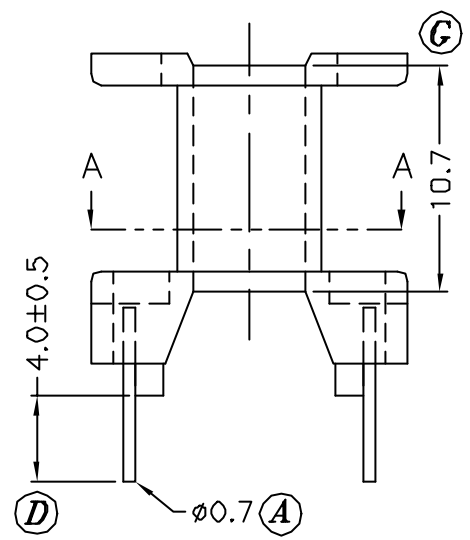
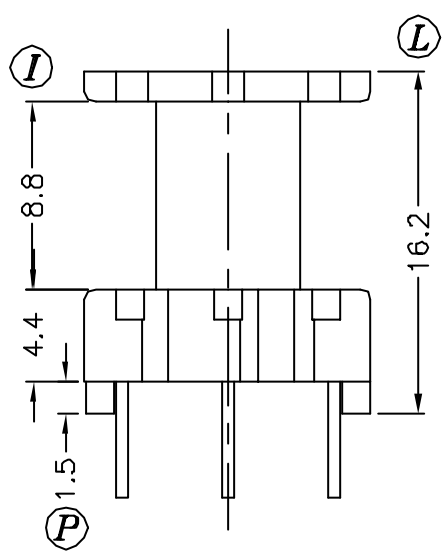

REV.	REVISIONS	REC.	REV.	REVISIONS	REC.
1	(P):1.0 CHANGE TO 1.5; (L):15.7 CHANGE TO 16.2				
2	CANCEL (D); UPDATE DRAWING				

DRAWN & DRAFTED BY WNCH HSIANG	TOLERANCES		ANGLE:	TITLE:	
	0<L≤4 ±0.1	pin pitch ±0.2	±1°	T-H BOBBIN EE-19	
CHECKED & APPROVED BY CHIN TE	4<L≤16 ±0.2		UNIT:	BOBBIN MATERIAL:	UL REC.
	16<L≤63 ±0.3	MM	PBT 4130	UL 94V-0	
 PIN SHINE INDUSTRIAL CO.,LTD. TEL:886-2-22990545 FAX:886-2-22990546	ORIGIN:	PIN MATERIAL:	PIN TENSION LOAD:		
	DG SZ	CP WIRE	1.5KG MIN		
	DATE:	DRAWING NO.	REV.		
	APR.01 '2003	P-1904	2		